

BLACK EDGE TRIM

The aesthetic finish of your flat roof

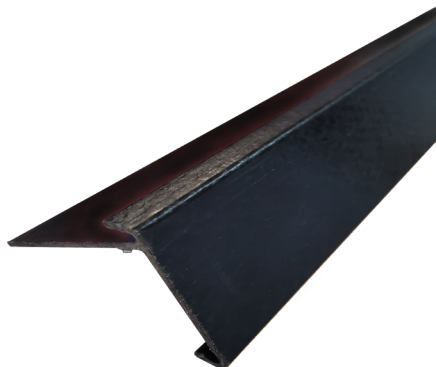

Product description

Finish your roof in style with our new Black Edge Trim. It is made from high-quality polyester to which fibreglass has been added. This makes our **BLACK EDGE TRIM** very sturdy and impact-resistant. It is impervious to ageing and weather conditions. The edge trim will not rust or oxidise, even where it is cut.

Application

It can be used on flat roofs with bitumen roofing rolls or EPDM roofing.

Advantages

- Strong and shock resistant
- Stylish
- Cannot rust or oxidise

How much product do I need?

Per running metre

Handy tips?

- The **BLACK EDGE TRIM** is coloured throughout, making scratches virtually invisible.
- The edge trim consist of a high-quality polyester resin reinforced with 30% fibreglass.
- Separate corner pieces are not required. Corners are easily created by mitre-cutting the trim.
- There are two ways to install the trim. It depends on the roofing material that you choose.

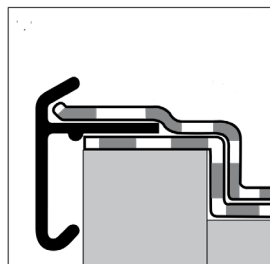
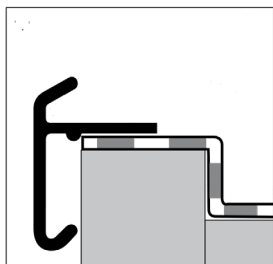

Material	Colour	Length	Height	Depth
Polyester	Black	2 m	65 mm	60 mm

BLACK EDGE TRIM

The aesthetic finish of your flat roof



INSTRUCTIONS

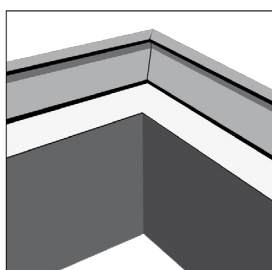
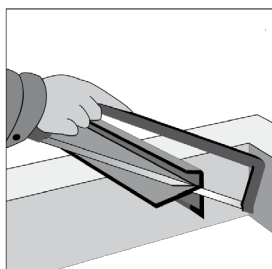
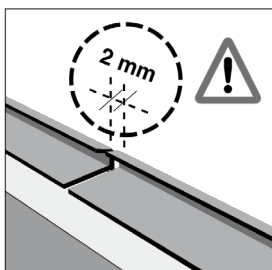
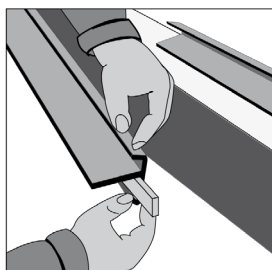
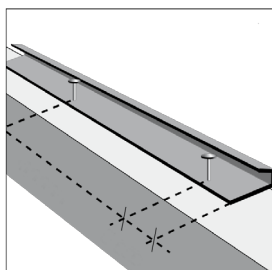

What do I need?



How do I use the product with bitumen roofing rolls?

- Place the edge trim on the underlay of your roof.
- Fasten our **EDGE TRIM SCREWS** 5 cm from the end of the edge trim, then fasten a new screw every 25 cm.
- Take a straight connector piece and insert it into the vertical section of the next edge trim.
- Place this next edge trim 2 mm from the previous one.
- To make a corner, you can easily mitre-cut two edge trim pieces. Use a corner connector to ensure a perfect fit.
- Finally, place the top layer of your roof covering over the edge trim. To ensure a waterproof finish, you can seal the edge trim under the upper lip with **ROOF SEAL MASTIC**.

How do I use the product with EPDM?

- Place the edge trim on the EPDM layer of your roof.
- Fasten the edge trim with our **BLACK EDGE TRIM SCREWS** 5 cm from the end of the edge trim, then fasten a new screw every 25 cm. These screws have an EPDM washer, so additional sealing is not necessary.
- Take a straight connector piece and insert it into the vertical section of the next edge trim.
- Place this next edge trim 2 mm from the previous one.
- To make a corner, you can easily mitre-cut two edge trim pieces. Use a corner connector to ensure a perfect fit.

Would you like more information?

We are ready to answer all your questions.

Feel free to contact us:

Belgium: 03 248 30 00 or info@aquaplan.com

The Netherlands: 0162 42 29 00 or verkoop-dhz@martensgroep.eu

Website: www.aquaplan.com

